

# DIN 976-1

Barra filettata tipo A, estremità filettata grezza (RL) secondo DIN EN ISO 4753

Stud bolt type A, with As-rolled (RL) type thread end as in DIN EN ISO 4753

Disponibile/Available A4 

A2 



$u$  (filetto incompleto):  $2 P$  max.  
 $u$  (incomplete thread):  $2 P$  max.

As-rolled end (RL)

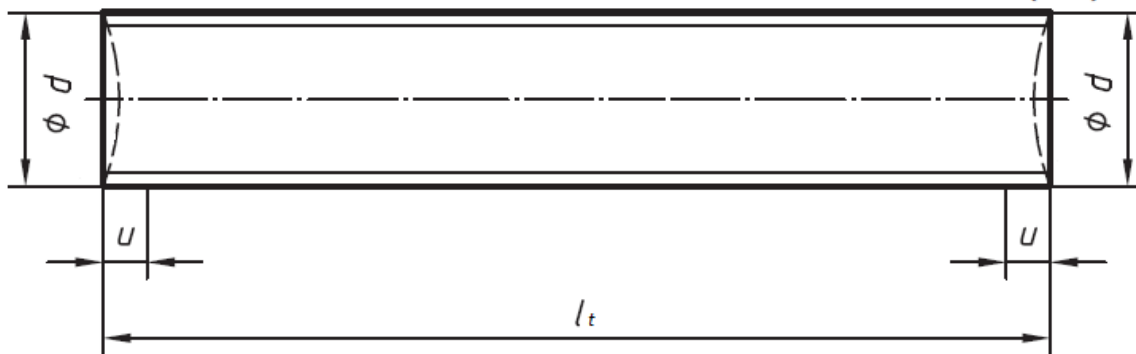

Thread size, $d$ tolerance class 6g			M2x0,4	M2,5x0,45	M3x0,5	(M3,5x0,6)	M4x0,7	M5x0,8	M6x1	M8x1,25	M10x1,5	M12x1,75					
			-	-	-	-	-	-	-	-	M8x1	M10x1,25	M12x1,25				
			-	-	-	-	-	-	-	-	M10x1	M12x1,5					
$l_t$			<b>Mechanical properties</b> $3 \text{ mm} \leq d \leq 24 \text{ mm}$ A2-70 / A4-70														
Nom. Size	min.	max.															
1000	995,5	1004,5					ON REQUEST										
2000	1992,5	2007,5	ON REQUEST	ON REQUEST	ON REQUEST	ON REQUEST	ON REQUEST										
3000	2989,5	3010,5	ON REQUEST	ON REQUEST	ON REQUEST	ON REQUEST	ON REQUEST										
Thread size, $d$ tolerance class 6g			(M14x2)	M16x2	(M18x2,5)	M20x2,5	(M22x2,5)	M24x3	(M27x3)	M30x3,5	(M33x3,5)	M36x4					
			(M14X1,5)	M16X1,5	(M18X1,5)	M20X1,5	(M22X1,5)	M24X2	(M27X2)	M30X2	(M33X2)	M36X3					
			-	-	-	-	-	-	-	-	-	-					
$l_t$			<b>Mechanical properties</b> $3 \text{ mm} \leq d \leq 24 \text{ mm}$ A2-70 / A4-70														
Nom. Size	min.	max.															
1000	995,5	1004,5															
2000	1992,5	2007,5					ON REQUEST					ON REQUEST	ON REQUEST				
3000	2989,5	3010,5													ON REQUEST		
Thread size, $d$ tolerance class 6g			(M39x4)	M42x4,5	(M45x4,5)	M48x5	(M52x5)	M56x5,5	(M60x5,5)	M64x6	(M68x6)	-					
			(M39X3)	M42X3	(M45X3)	M48X3	(M52X3)	M56X4	(M60X4)	M64X4	(M68X4)	M72X6					
			-	-	-	-	-	-	-	-	-	-					
$l_t$			<b>Mechanical properties</b> $3 \text{ mm} \leq d \leq 24 \text{ mm}$ A2-70 / A4-70														
Nom. Size	min.	max.															
1000	995,5	1004,5							ON REQUEST	ON REQUEST	ON REQUEST	ON REQUEST	ON REQUEST	ON REQUEST	ON REQUEST		
2000	1992,5	2007,5	ON REQUEST	ON REQUEST	ON REQUEST	ON REQUEST	ON REQUEST	ON REQUEST	ON REQUEST	ON REQUEST	ON REQUEST	ON REQUEST	ON REQUEST	ON REQUEST			
3000	2989,5	3010,5	ON REQUEST	ON REQUEST	ON REQUEST	ON REQUEST	ON REQUEST	ON REQUEST	ON REQUEST	ON REQUEST	ON REQUEST	ON REQUEST	ON REQUEST	ON REQUEST			

Evitare i diametri tra parentesi se possibile/ Bracketed sizes should be avoided if possible.

last edit 13/05/2020

DRAWING N. 1147